

Spindle bearings HC7003-C-T-P4S-UL

adjusted, in pairs or sets, contact angle $\alpha = 15^\circ$, with ceramic balls, restricted tolerances

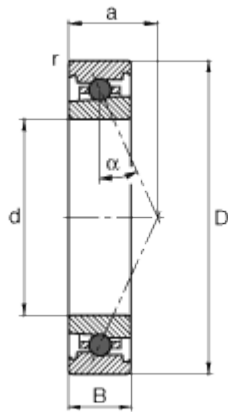

d	17 mm	
D	35 mm	
B	10 mm	
a	11 mm	
D_a	29 mm	Tolerance: H12
d_a	22,5 mm	Tolerance: h12
r_{a max}	0,3 mm	
r_{min}	0,3 mm	
α	15 °	Contact angle



m	0,042 kg	Mass
C_r	3350 N	Basic dynamic load rating, radial
C_{0r}	1460 N	Basic static load rating, radial
n_{G Fett}	75000 1/min	Limiting speed for grease lubrication
n_{G Öl}	110000 1/min	Limiting speed for minimal quantity oil lubrication
C_{ur}	111 N	Fatigue limit load, radial

