

## Spindle bearings HC7021-C-T-P4S-UL

adjusted, in pairs or sets, contact angle  $\alpha = 15^\circ$ , with ceramic balls, restricted tolerances

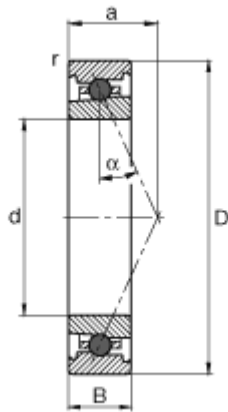

<b>d</b>	105 mm	
<b>D</b>	160 mm	
<b>B</b>	26 mm	
<b>a</b>	44 mm	
<b>D<sub>a</sub></b>	143,5 mm	Tolerance: H12
<b>d<sub>a</sub></b>	121 mm	Tolerance: h12
<b>r<sub>a max</sub></b>	2 mm	
<b>r<sub>min</sub></b>	2 mm	
<b>α</b>	15 °	Contact angle



<b>m</b>	1,59 kg	Mass
<b>C<sub>r</sub></b>	45000 N	Basic dynamic load rating, radial
<b>C<sub>0r</sub></b>	33000 N	Basic static load rating, radial
<b>n<sub>G Fett</sub></b>	14000 1/min	Limiting speed for grease lubrication
<b>n<sub>G Öl</sub></b>	22000 1/min	Limiting speed for minimal quantity oil lubrication
<b>C<sub>ur</sub></b>	2180 N	Fatigue limit load, radial

